



# ALL SOUTH FLOORING



Blue Ridge Collection

Locking System – Installation Instructions

# BlueRidge SolutionCore

featuring i4F 3L Triple Lock

ATTENTION – PLEASE READ BEFORE INSTALLING

**Important:** Carefully inspect all boards for any defects. *Planks installed with visible defects are not covered under warranty.* It's the responsibility of the installer/owner for the suitability of ACE flooring and accompanying products. Please do not install any plank or tile that is considered questionable in appearance or dimensions.

## **FOR BEST VISUAL REPRESENTATION OF YOUR FLOOR**

This flooring replicates the look of a natural product which has natural variations in color, texture, and sheen/gloss. For best visual effect, work from 3-4 boxes and shuffle planks or tiles. Avoid installing similar planks or tiles next to one another

## **SUBFLOOR PREPARATION & MOISTURE**

Subfloor should be dry and level to 3/16" per 10 ft. radius for best installation results.

While this product is waterproof, it's not a moisture barrier. Moisture won't damage this product, but it can get in the walls and structure of the home. It's still a good idea to make sure your concrete is cured and tested for moisture.

Because houses and buildings, as well as adjacent hardwood or laminate floors, expand and contract, ACE recommends to leave a 1/4" expansion gap between the perimeter walls and any adjacent hardwood floor.

## **PRE-INSTALLATION SUBFLOOR REQUIREMENTS**

All Subfloors must be:

- Dry
- Structurally sound
- Clean: Thoroughly swept and free of all debris
- Level: Flat to 3/16" per 10-foot radius

Wood subfloors must be dry and well secured. Nail or screw every 6" along joists to avoid squeaking. If not level, sand down high spots and fill low spots with a Portland Based leveling patch.

Concrete subfloors should be fully cured, at least 60 days old. Subfloor should be flat and level within 3/16" per 10' radius. If necessary grind high spots down and level low spots with a Portland leveling compound.



The world's **easiest**  
flooring installation system



PATENTS & TECHNOLOGIES



*"Our one piece drop-lock system, is fast becoming the industry standard as it offers a quicker, more cost-effective way to manufacture drop-lock solutions in a sustainable way and installation is so easy, anyone can do it!"*

John Rietveldt | CEO

## Our unique patented floor locking systems

Discover the world's easiest one piece drop-lock system on the market for patented floor locking systems:

**3L TRIPLELOCK AND CLICK4U.** Suitable for use on all flooring materials.

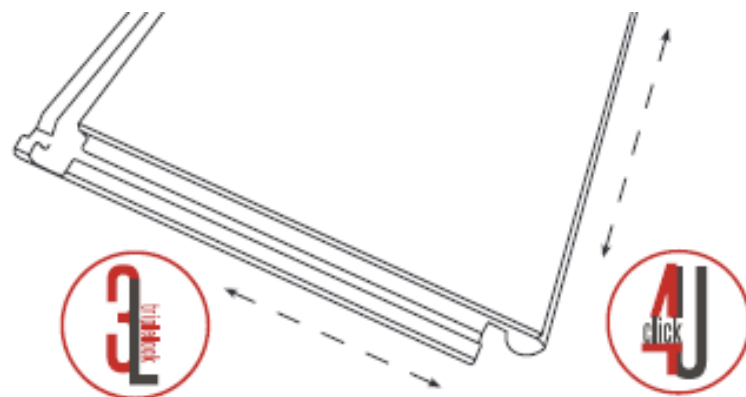

### 3L TRIPLELOCK

A one piece drop-lock system for the short side that eliminates the need for additional plastic inserts

3L TripleLock provides a unique one piece drop-lock installation technique for flooring panels that eliminates the need for an additional insert on the short side. This elimination provides manufacturers with the possibility to improve productivity levels as well as to reduce their costs and carbon footprint. The 3L TripleLock click system is suitable for existing high speed production.

### CLICK4U

An angle-system for the long side combined with 3L TripleLock on the short side

The angle system has proven itself for many years and combined with the drop-lock on the short side the locking strength is very high. Just like 3L TripleLock, Click4U is suitable for existing high speed production machinery. The system has multiple installation benefits as well. It is fast and easy to install and installation does not require special tools.



## Benefits & Advantages

### Benefits for manufacturers

- Unique one piece drop-lock installation system for flooring panels
- No plastic inserts needed, reducing costs
- Improves productivity levels
- Suitable for high-speed machines

### Benefits for consumers

- Meets all EN performance standards
- Easy to install – up to 30% faster than traditional angle/angle systems
- Avoids squeaking
- Suitable for all materials including luxury vinyl tiles, rigid core flooring (RCF), multi-layer flooring (MLF), laminate and wooden flooring panels.
- No special tools needed

## Get the Best

Tried and tested over the last years by the world's leading global flooring manufacturers, no other one piece drop-lock solution has undergone such breadth of testing to offer a superior installation system across all types of flooring.

### 3L TripleLock and Click4U meet all EN standards

I4F uses independent and highly regarded institutes for all its product tests. These institutes, such as the German Institute IHD, are recognized by the flooring industry and have tested the patented designs for locking strength, flatness and gaps.

3L TripleLock and Click4U have both passed the following tests

- |                                     |                     |                                     |                     |
|-------------------------------------|---------------------|-------------------------------------|---------------------|
| <input checked="" type="checkbox"/> | Qestor Chair test   | <input checked="" type="checkbox"/> | Static Locking test |
| <input checked="" type="checkbox"/> | Click Strength test | <input checked="" type="checkbox"/> | Cupping test        |
| <input checked="" type="checkbox"/> | Gapping test        | <input checked="" type="checkbox"/> | Vertical Load test  |



ONE PIECE  
DROP-LOCK



NO SPECIAL  
TOOLS  
REQUIRED



30% FASTER  
INSTALLATION



NO  
SQUEAKING



SUITABLE  
FOR ALL  
MATERIALS



MEETS ALL  
PERFORMANCE  
STANDARDS



SUSTAINABLE



EASIER  
PRODUCTION



COST-  
EFFECTIVE